

15

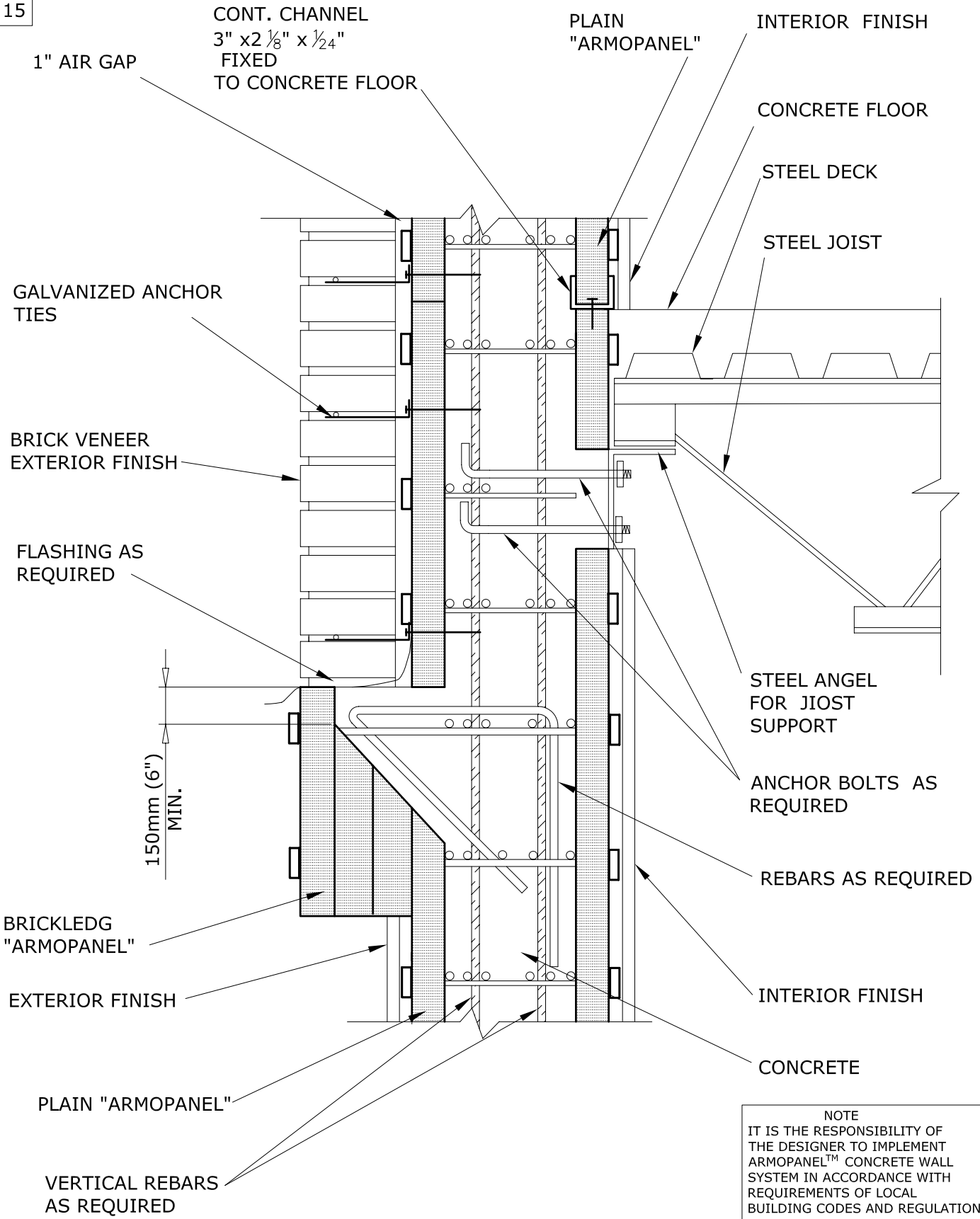

NOTE
 IT IS THE RESPONSIBILITY OF
 THE DESIGNER TO IMPLEMENT
 ARMOPANEL™ CONCRETE WALL
 SYSTEM IN ACCORDANCE WITH
 REQUIREMENTS OF LOCAL
 BUILDING CODES AND REGULATIONS

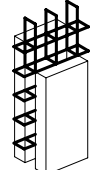

**HI-TECH BUILDING
 SYSTEMS
 CORPORATION**

B-57 Corstate Ave.
 Concord, Ontario,
 L4K 4Y2, Canada
 Tel: (905)738-0567
 Fax: (905)738-0628
 E-mail: htbs@connection.com

**Armopanel™
 Wall System**

**HAMBRO® COMPOSITE FLOOR AND
 CONCRETE WALL CONNECTING
 DETAIL**

REV. NO.	REV. DATE:	FILE:	DWG NO.
DRAWN BY PR	DATE: 12/02/02	SCALE: N.T.S.	R-14